

<b>Report to:</b>	Licensing and Regulatory (Urgent Referrals) Committee	<b>Date of Meeting:</b>	28 July 2020
<b>Subject:</b>	Great Georges Road Walking and Cycling Improvements		
<b>Report of:</b>	Head of Highways and Public Protection	<b>Wards Affected:</b>	Church;
<b>Portfolio:</b>			
<b>Is this a Key Decision:</b>	No	<b>Included in Forward Plan:</b>	No
<b>Exempt / Confidential Report:</b>	No		

**Summary:**

To seek Members' approval for the implementation of the Great Georges Road Walking and Cycling Scheme.

**Recommendation(s):**

It is recommended that the Head of Highways and Public Protection be authorised to implement the following modifications to the highway:

- (1) Segregated cycle infrastructure along the length of Great Georges Road, Waterloo.
- (2) Improvements to the pedestrian and cycle crossing point at 5 Lamps Junction Waterloo.
- (3) Installation of raised tables at the junctions along Great Georges Road.
- (4) Installation of crossing point to Crosby Coastal Park for people walking and cycling.

**Reasons for the Recommendation(s):**

Licensing and Regulatory Committee have powers to consider the outcome of consultation and the resultant proposals in respect of the making of traffic regulation orders, details of improvements to highways and cycle routes and can approve the scheme as proposed or with minor amendments but otherwise must refer the scheme to the Cabinet Member

**Alternative Options Considered and Rejected:** (including any Risk Implications)

None. The measures proposed form a key element of the walking and cycling networks in the local area and for longer journeys connecting north and south of the borough.

**What will it cost and how will it be financed?**

**(A) Revenue Costs**  
None

**(B) Capital Costs**  
The scheme will be delivered as part of the LCR Local Growth Fund STEP (Sustainable Transport Enhancement Package) Initiative (scheme 8) for which a budget of £1,786k was established. This budget however, has also funded other works within the corridor. An allocation of £683k will therefore be utilised from STEP with a further allocation of £267k from the Integrated Transport Block Grant to fully fund this scheme, bridge maintenance and repair works for the structure which carries the A565 over the railway.

**Implications of the Proposals:**

<b>Resource Implications (Financial, IT, Staffing and Assets):</b> None
<b>Legal Implications:</b> None
<b>Equality Implications:</b>  The scheme has positive equality implications as the provision of segregated cycling facilities provides a low cost means of transport to a wider section of the community, younger people, older people and those who are new to cycling.

**Contribution to the Council's Core Purpose:**

Protect the most vulnerable: By creating a viable and connected cycling network this will facilitate safe and efficient travel for those caring for the most vulnerable in our community.
Facilitate confident and resilient communities: To improve walking and cycling network in the local area and offer the opportunity to a wider section of the community an alternative method of travel to public transport and private car for shorter journeys.
Commission, broker and provide core services: n/a
Place – leadership and influencer: To improve the liveability of the area by promoting walking and cycling in the local area and beyond.

Drivers of change and reform: n/a
Facilitate sustainable economic prosperity: By encouraging local journeys on foot and by bike.
Greater income for social investment: n/a
Cleaner Greener: Supports sustainable travel; leisure and utility walking and cycling connecting waterloo to the wider Active Travel network.

## What consultations have taken place on the proposals and when?

### (A) Internal Consultations

The Executive Director of Corporate Resources and Customer Services (FD6048/20) and the Chief Legal and Democratic Officer (LD4231/20) have been consulted and any comments have been incorporated into the report.

### (B) External Consultations

Immediately following the Committee / Council meeting.

<b>Contact Officer:</b>	Lee Victoria Davies
Telephone Number:	
Email Address:	lee.davies@sefton.gov.uk

### Appendices:

The following appendices are attached to this report:

- Appendix A The Scheme Design
- Appendix B The Consultation Leaflet
- Appendix C The Final Scheme Design

### Background Papers:

There are no background papers available for inspection.

## 1. Introduction/Background

- 1.1 The Council completed a study, some years ago, entitled the A565 Route Management Strategy, which aimed at identifying the issues along the corridor which contributed to congestion for motorists at peak periods and difficulties for pedestrians and cyclists. The report identified a series of potential improvement measures at many of the key junctions along the route and this in turn led to a number of projects being included within the Council's Transport Capital Programme. The most recently completed scheme was the modification to the junction of Crosby Road South with South Road and Haigh Road. This involved the acquisition of land in order to provide some localised widening to ease traffic flow and improve crossing points. The scheme was completed in 2017.
- 1.2 The Route Management Strategy identified the Five Lamps junction as a source of congestion during the morning and afternoon peak hours. It also identified the junction as having a record of accidents, poor air quality and poor facilities for pedestrians and cyclists. Further studies of the junction identified the frequent and sometimes sudden change of lanes as drivers traveling straight on move lanes to avoid vehicles turning right into Bramhall Lane. It was also noted that cyclists experienced some difficulty accessing the existing controlled crossing point over the A565
- 1.3 There is the intention to create an inland cycling and walking link through Crosby Coastal Park, which would avoid the problems with blown sand on the seafront path. Works at the 5 lamps junction provide an opportunity for enhancing the pedestrian and cycle crossing over the A565 and to provide measures on Great Georges Road to create an segregated cycle link along the length of road. This scheme will improve walking and cycling links from Crosby Coastal Park to Bootle and Litherland via the enhanced walking and cycling crossing over the A565.

## 2. The Scheme Design

- 2.1 The scheme was designed to provide a safe, segregated cycle facility along the length of Great Georges Road and provide an enhanced pedestrian environment by removing clutter and the provision of raised tables at the junctions. The scheme was also designed to address the problems identified with crossing the A565 Crosby Road North. The scheme design (**Appendix A**) which was subject to consultation has the following key features:
  - Improved pedestrian and cyclists crossing at 5 lamps junction
  - Linked with the above is the removal of the left turn out of Great Georges Road onto A565
  - The introduction of one way traffic flow for vehicles at the side roads
  - A two-way segregated cycle route along the length of Great Georges Road
  - The provision of a safe pedestrian and cycle crossing at the junction with Marine Terrace to access Crosby Coastal Park
  - Raised tables at the side road junctions to offer an at grade walking experience
  - The reduction of street clutter, including redundant signs, bollards, and guard railings

### 3.0 The Consultation

- 3.1 The consultation took the form of an information booklet (**Appendix B**) and an online consultation questionnaire on the corporate Your Sefton Your Say website. Both the information booklet and the online questionnaire were subject to scrutiny by our Information Advocates to ensure they met our information standards.
- 3.2 The consultation went live on Monday 3rd February and closed on Monday 2nd March. There were 3 drop in events as follows:
- Crosby Lakeside Adventure Centre – Tuesday 4th February 5pm until 8pm
  - Waterloo Community Centre – Thursday 6th February 11 am until 2pm
  - Crosby Library – Friday 6th February 12 noon until 4pm
- 3.3 In addition to the drop in events people could look at detailed plans and fill in a paper copy of questionnaire at Crosby Library.

### 4.0 Consultation Results

- 4.1 There were 60 responses to the consultation and two personal letters (both of which were received after the closing date but the content will be taken into account) There was a further 1 paper response which was submitted after the closing date.
- 4.2 68% of the respondents lived in the area and were mostly aged between 50 and 69. Younger people were not represented in the responses, there were no respondents who were under 18 and only 3% were between 18 and 29. There was an equal split of males and females in the responses. 6% of the respondents considered themselves as having a disability.
- 4.3 68% of the respondents identified as living in the area and 46% of the respondents travel by car as a driver or passenger. 20% of respondents travel by bicycle or bike/rail and 18% on foot. In relation to the drop in sessions, attendees mainly identified as living on Great Georges Road.
- 4.4 The responses to the questions are as follows:

#### *How you usually travel*

- 32 (53%) people described their usual travel mode as by car driver and car passenger
- 11 (18%) people travelled by foot
- 12 (20%) people cycled or travelled by bike & rail.
- 5 (8%) people travelled by bus

#### *What do you think about our ideas to make Great Georges Road easier to walk along and cross the side roads?*

- 33 people (55%) said they were very or fairly happy
- 10 people (17%) said they didn't know or were undecided
- 17 people (28%) said they were not very happy or not happy at all.

#### *What do you think about our ideas for a separate cycle lane along Great Georges Road?*

- 28 people (47%) said they were very or fairly happy.
- 12 people (20%) said they didn't know or were undecided.
- 20 people (33%) of people said they were not very happy or not happy at all.

*What do you think about our ideas to make it easier to get to Crosby Coastal Park by including a shared crossing point for people walk and cycling at the junction with Marine Terrace?*

- 33 people (55%) said they were very or happy
- 8 people (13%) said they didn't know or were undecided
- 19 people (32%) said they were not very happy or not happy at all.

*What do you think about our ideas to change the way the traffic will move around the side roads?*

Raised tables at the side roads (similar to the picture below)

- 31 people (52%) said they were very or fairly happy
- 12 people (20%) said they didn't know or were undecided
- 15 people (25%) said they were not very happy or not happy at all
- 2 people (3%) did not provide an answer.

*Making the side roads one way only for traffic (similar to the picture below)*

- 27 people (45%) said they were very or fairly happy
- 11 people (18%) said they didn't know or were undecided
- 21 people (35%) said they were not very happy or not happy at all
- 1 person (2%) did not provide an answer.

*Narrowing the entrances of the side roads*

- 28 people (47%) said they were very or fairly happy
- 9 people (15%) said they didn't know or were undecided
- 21 people (35%) were not very happy or not happy at all
- 2 people (3%) did not provide an answer

*Do nothing and leave them as they are*

- 23 people (38%) said they were very happy or fairly happy
- 13 people (22%) said they were undecided
- 20 people (33%) said they were not very happy or not happy at all
- 4 people (7%) did not provide an answer.

*What do you think about our ideas to have parking on one side of Great Georges Road?*

- 27 people (45%) said they were very or fairly happy
- 12 people (20%) said they were undecided or didn't know
- 21 people (35%) said they were not very happy or not happy at all.

What do you think about our ideas to improve the shared crossing for people walking and cycling at Five Lamps / A565 Crosby Road North

- 27 people (45%) said they were very or fairly happy
- 16 people (27%) said they were undecided or didn't know
- 17 (28%) people said they were not very happy or not happy at all.

*What do you think about our ideas to only allow traffic to turn right out of Great Georges Road junction onto the A565 Crosby Road North?*

- 22 people (37%) said they were very or fairly happy
  - 13 people (22%) said they didn't know or were undecided
  - 23 people (38%) were not very happy or not happy at all
  - 2 people (3%) did not answer
- Overall What do you think of our ideas?*
- 31 people (52%) said they were very or fairly happy
  - 6 people (10%) were undecided or didn't know
  - 23 people (38%) said they were not very happy or not happy at all.

4.5 Generally, the scheme was well received as demonstrated by the answer to the overall approval question:

*Overall What do you think of our ideas?*

- 31 people (52%) said they were very or fairly happy
- 6 people (10%) were undecided or didn't know
- 23 people (38%) said they were not very happy or not happy at all

4.6 Merseyside Police, Emergency Fire & Rescue and North West Ambulance Service were consulted. The response from Merseyside Police is as follows:

*On behalf of Merseyside Police I am unable to support the proposals due to the proposed removal of the left hand turn out of Great Georges Road onto A565 Crosby Road North. Whilst Merseyside Police are in support of highways upgrades or changes that improve the safety of all road users I am unable to support this change.*

- *North Response & Resolution are based at Crosby Police Station and are responsible for attending 999 emergency calls in the Sefton area. As a result there are up to 40 officers on duty at any time. Whether officers are heading out on patrol or responding to an emergency call they need to be able to turn left and right when exiting Great Georges Road onto A565 Crosby Road North.*
  - *Access/egress to the police station is via the entrance situated on Great Georges Road opposite Walmer Road. This entrance has had security enhancements in recent years and the gates open and close automatically to allow police vehicles to pass through them. This entrance is controlled by a key code and has an intercom and CCTV capability.*
  - *Crosby Police Station is located on Alexandra Road and has a vehicle access gate this has not be in use for many years. It is only used as a contingency and requires manual operation and does not have the facility to be operated remotely. Therefore using this entrance is not an alternative.*
- I do not have any objections to the proposed changes to Walmer Road becoming a One Way; proposed footways & cycleways. Raised tables at the junctions do not hinder our patrols.*

4.7 Merseyside Fire and Rescue and North West Ambulance Service responded with no objections.

## 5.0 Response to Issues Raised

There are several issues which emerged from the comments sections on the questionnaire, the consultation drop in sessions and internal consultation with Council Officers. The issues were centred around residential parking, the left hand turn out of Great Georges Road, the location of the crossing to improve access to Crosby Coastal Park and the location of the cycle route.

1. *The reduction of on street parking along Great Georges Road was a concern of many residents we spoke to during the events and it features as a key theme in the consultation returns.*

Our initial findings indicated there would be enough kerbside space to accommodate parking demand for residents and their visitors along one side of Great Georges Road. Most residencies along Great Georges Road have access to off street parking. However, there are a very small number of properties that we know of who do not have off street parking. Residents were very concerned that the scheme would reduce parking and not leave enough for residents to park.

Given the current situation with COVID-19 and the likelihood traffic patterns will take a considerable time to return back to pre COVID-19 levels, it is suggested that the scheme continues as planned. However, parking surveys will be completed when traffic patterns return to normal and allow consideration to be given to whether non residential traffic is impacting on available parking. This data will be used to review whether mitigation measures are appropriate to mitigate the loss of on street parking resulting from the creation of the cycle lane. Any measures, which could include consideration of a residents parking scheme, will developed later in 2020 and may be delivered as part of, or after the scheme.

2. *The removal of the left hand turn when travelling from Great Georges Road to A565 was a great concern for a small number of residents who advised they regularly make this traffic manoeuvre.*

Banning the left turn manoeuvre unlocks many benefits for pedestrians, cyclists and vehicle drivers travelling towards Crosby and to Liverpool. There are a small number of residents who advised they regularly make this manoeuvre. Merseyside Police have advised they cannot support the removal of the left hand turn as outlined in Section 3.0. Therefore, the final design will allow for left hand turning traffic out of Great Georges Road onto the A565.

3. *The positioning of the pedestrian and cycle crossing to access Crosby Coastal Park.*

The Conservation Officer raised issues relating to the positioning of the crossing. This has been amended from the initial design. The scheme will also be subject to a Road Safety Audit.



4. *There was also a feeling amongst residents that the cycle route should run along Cambridge Road.*

Cambridge Road is an advisory cycle route and it links route 810 to the shared use path long the A565 which continues past the Port of Liverpool to the City. Cambridge Road is far narrower and would not offer the opportunity to provide a high level of provision for cyclists or offer an easy link to Rimrose Valley and the canal.

## 6.0 The Final Scheme Design

- 6.1 The final scheme design (**Appendix C**) has been adjusted to take account of the results of the public consultation stakeholder engagement. There have been two changes to the design as shown in table A.

**Table A**

<b>Scheme design</b>	<b>Final scheme design</b>	<b>Reasoning</b>
Left hand turn manoeuvre for vehicles removed onto A565 Crosby Road North	Left hand turn and right hand turn manoeuvres for vehicles onto A565 Crosby Road North retained.	Design modified due to results of the consultation.
Crossing point to Crosby Coastal Park situated on the corner of Marine Terrace	Crossing point repositioned on Great Georges Road.	Due to conservation and resident concerns.

### **Recommendation(s):**

It is recommended that the Head of Highways and Public Protection be authorised to implement the following modifications to the highway:

- (1) Segregated cycle infrastructure along the length of Great Georges Road, Waterloo
- (2) Improvements to the pedestrian and cycle crossing point at 5 Lamps Junction Waterloo
- (3) Installation of raised tables at the junction along Great Georges Road, subject to TRO process being completed
- (4) Installation of crossing point to Crosby Coastal Park for people walking and cycling

# Appendix A The Scheme Design

## SELECTION OF OPTIONS FOR JUNCTION TREATMENTS

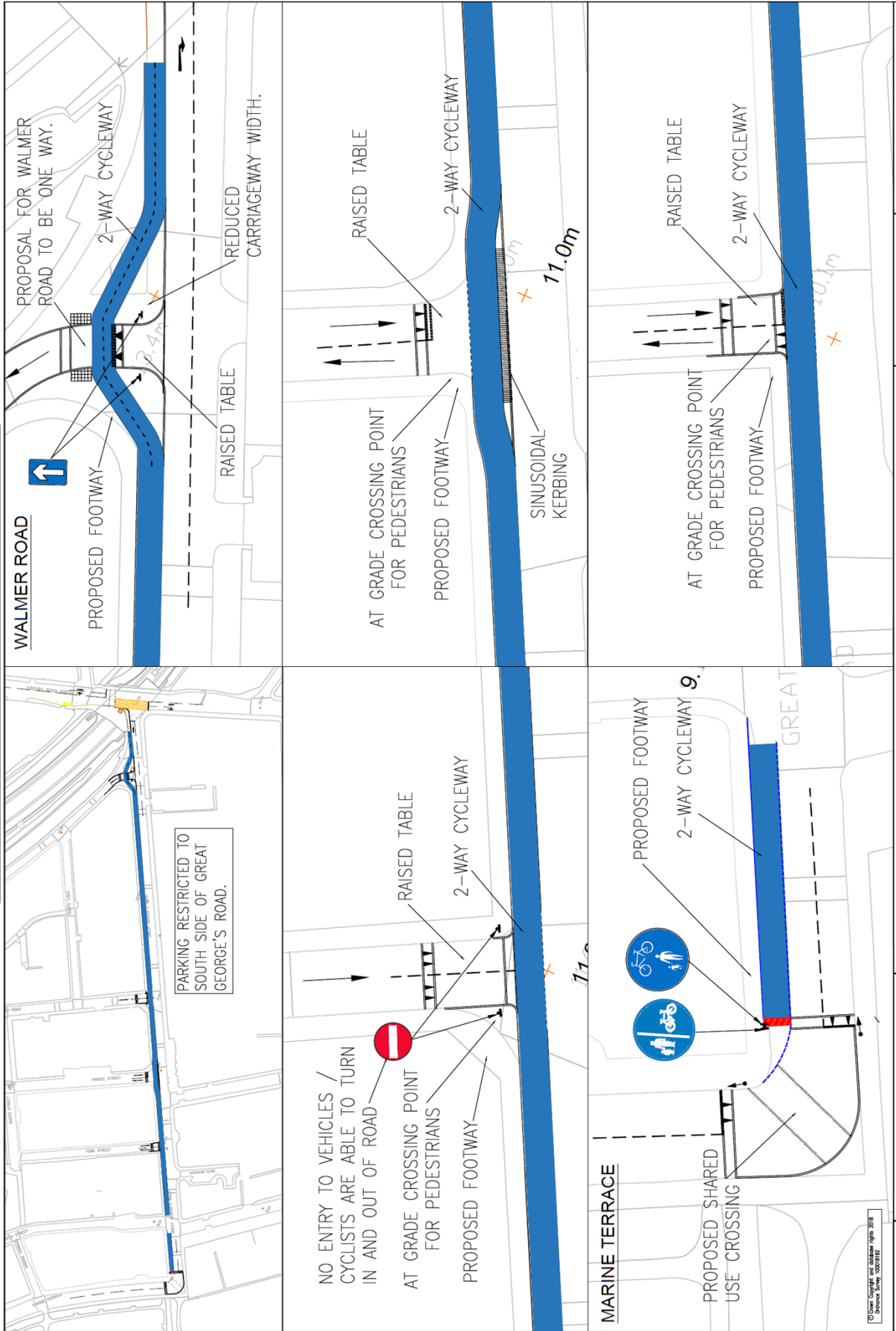

© Atkins copyright and trademark 1998-2018. All rights reserved.

You will be able to comment on our ideas until Monday 2<sup>nd</sup> March 2020

**See and Fill in**

Come and see plans and fill in a paper copy of the questionnaire at Crosby Library from Monday 27<sup>th</sup> January until Friday 7<sup>th</sup> February during normal library opening hours 10am until 5pm Monday to Friday and 10am until 2pm on Saturday.



**See and Talk**

Come and talk to us face to face and see plans, we will be available as follows:

**Crosby Lakeside Adventure Centre**, Crosby Coastal Park, off Cambridge Road, on Tuesday 4<sup>th</sup> February 2020 from 5pm until 8pm

**Waterloo Community Centre**, Great Georges Road on Thursday 6<sup>th</sup> February 2020 from 11am until 2pm

**Crosby Library**, Crosby Road North on Friday 7<sup>th</sup> February 2020 from 12noon until 4pm

If you need this information in a different format please contact us on 0345 140 0845 or email [transport.planning@sefton.gov.uk](mailto:transport.planning@sefton.gov.uk)



STRATEGIC INVESTMENT FUND

**GREAT GEORGES ROAD WALKING AND CYCLING IMPROVEMENTS**

Connecting Crosby Coastal Park to Five Lamps and beyond



[sefton.gov.uk/GreatGeorgesRoad](http://sefton.gov.uk/GreatGeorgesRoad)

We are seeking your views on our ideas to improve your local streets. We are looking at the length of Great Georges Road and the junction with the A565 known as 'Five Lamps' in Waterloo. We want to make the area an enjoyable place for everyone.



### Background

In July 2019, Sefton Council declared a Climate Change Emergency. This declaration commits the Council to reduce carbon emissions to net zero by 2030. The Council recognises that business as usual is no longer an option and that we all need to make changes to reduce our carbon emissions. Road transport is a large contributor to carbon emissions and also air pollution. The 2019 Public Health Annual Report on Air Quality identifies road transport as a major contributor to poor air quality in Sefton.

One way of helping us meet our carbon reduction target and to improve air quality is to encourage people to walk and cycle rather than use their cars. We want to make an environment where walking and cycling is more enjoyable, fun and the best way to travel.

### Great Georges Road

Our ideas include improving footways so that you can walk along the length of Great Georges Road at the same level. A separate cycleway from cars using the road would make it a safe route for family cycling. For these ideas to happen we would need to change the way the side roads work by making some of the side roads entry or exit for cars only. People walking or cycling would still be able to enter and exit all the side roads. This will make the junctions safer for everyone.

### Five Lamps Crossing

Our ideas include making the crossing point safer for people walking and cycling by providing them with more space and time to cross.

### Trees

Our ideas include planting more trees along the street. The number of new trees will depend on the amount of space under the footway that is free from gas, electricity and telecommunications cables. The number and location of the trees will be worked out as we develop our ideas.

### Car parking

To make room for our ideas we need to change the way cars park on Great Georges Road. Our ideas are to make parking available only on the same side as Waterloo Community Centre and St Thomas' Church with no parking on the other side of the road.





# Appendix C - The Final Scheme Design

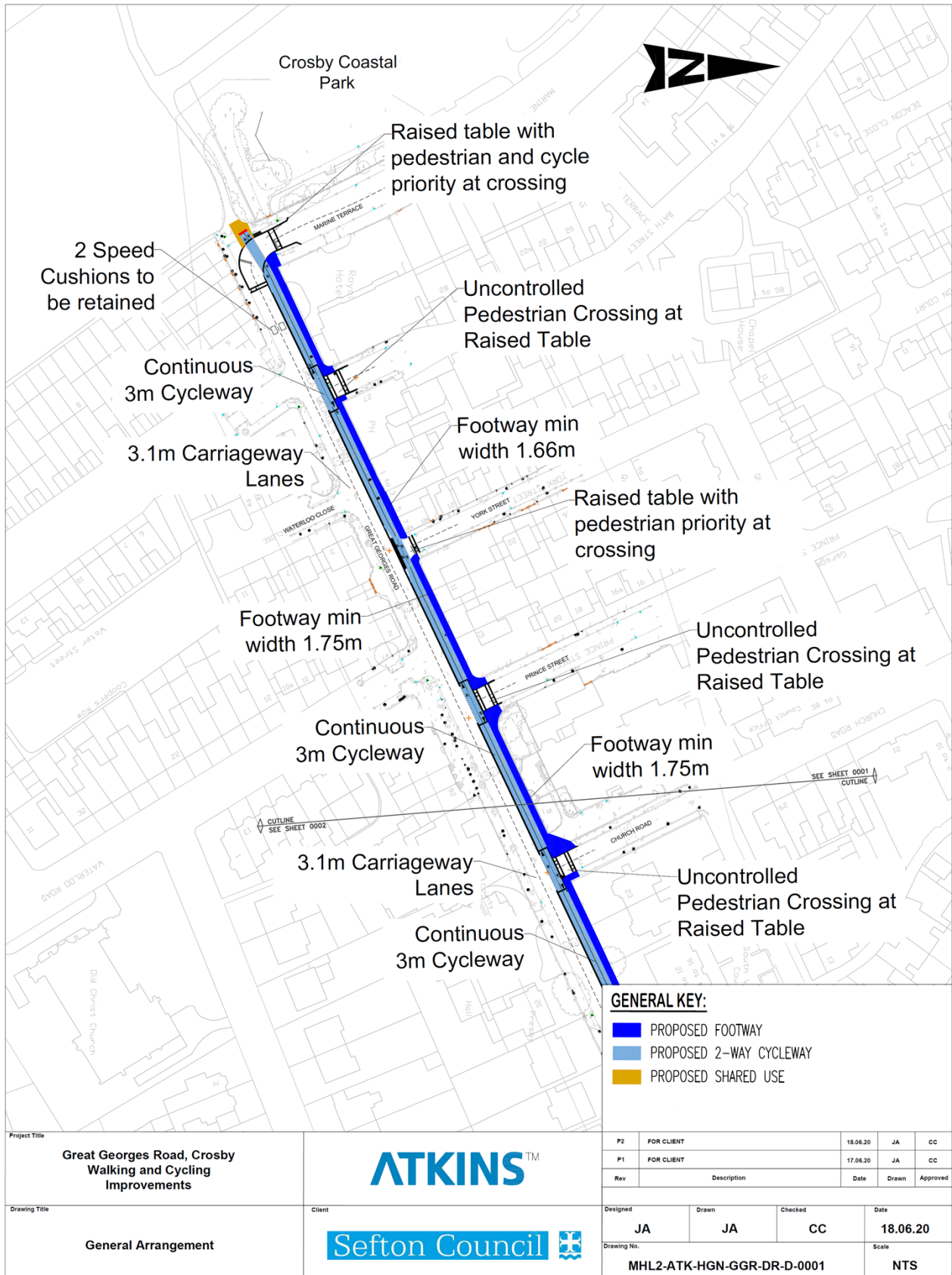

Project Title  
**Great Georges Road, Crosby  
 Walking and Cycling  
 Improvements**



P2	FOR CLIENT	18.06.20	JA	CC
P1	FOR CLIENT	17.06.20	JA	CC
Rev	Description	Date	Drawn	Approved

Drawing Title  
**General Arrangement**

Client  
**Sefton Council**

Designed	JA	Drawn	JA	Checked	CC	Date	18.06.20
Drawing No.	MHL2-ATK-HGN-GGR-DR-D-0001					Scale	NTS

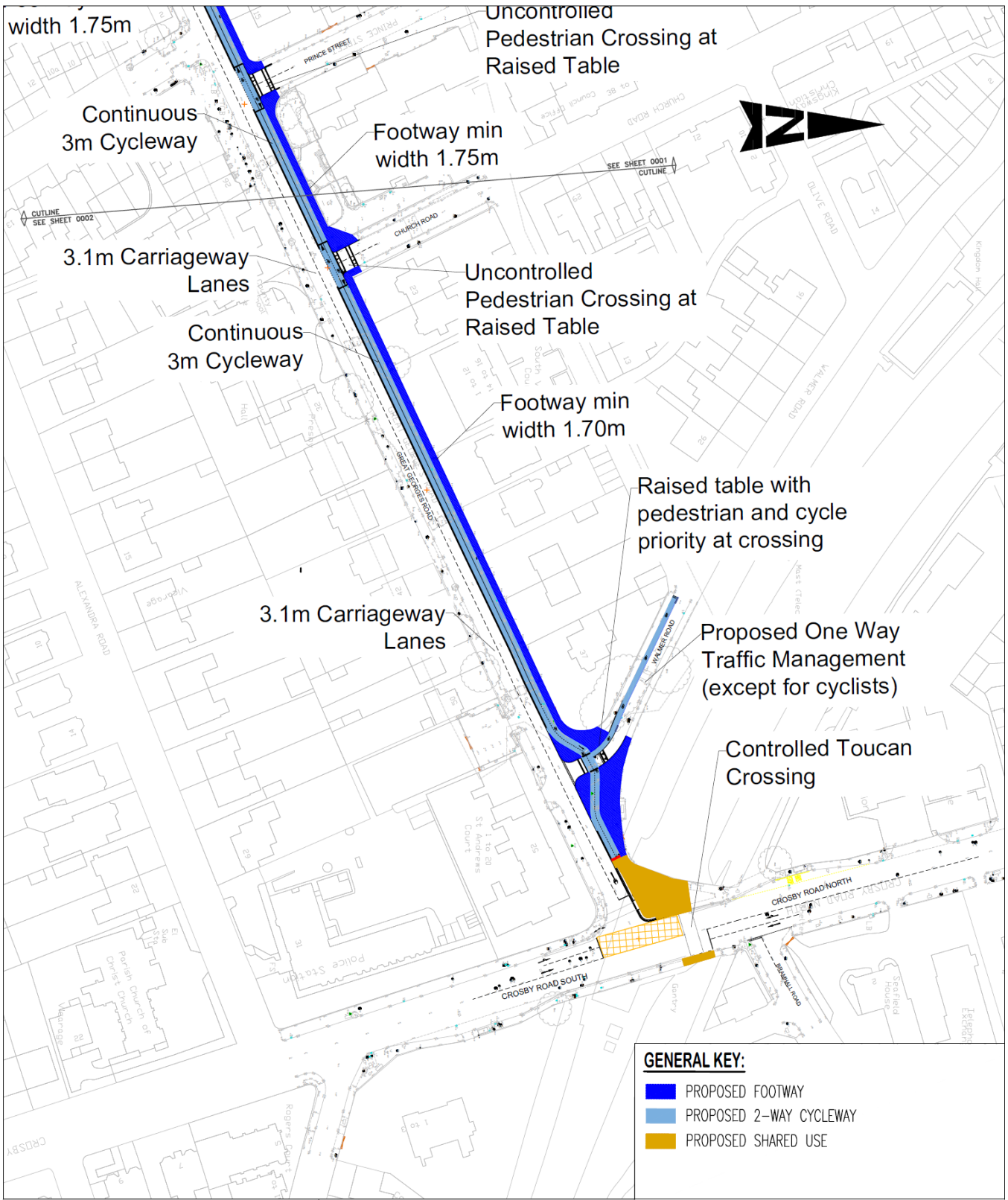

**GENERAL KEY:**

- PROPOSED FOOTWAY
- PROPOSED 2-WAY CYCLEWAY
- PROPOSED SHARED USE

Project Title  
**Great Georges Road, Crosby  
 Walking and Cycling  
 Improvements**

Drawing Title  
**General Arrangement**

Client  
  

P1	FOR CLIENT	18.06.20	JA	CC
Rev	Description	Date	Drawn	Approved
Designed	Drawn	Checked	Date	
JA	JA	CC	18.06.20	
Drawing No.	MHL2-ATK-HGN-GGR-DR-D-0002			Scale
				NTS

**INDICATION OF PROPOSED CROSS SECTION  
ON GREAT GEORGES ROAD**

